

# Setting up EZView app

---

1. Download the EZView app from the Apple App Store or the Google Play Store (depending on the type of device you are using).
2. Open the app, and click on the menu button (top left corner)

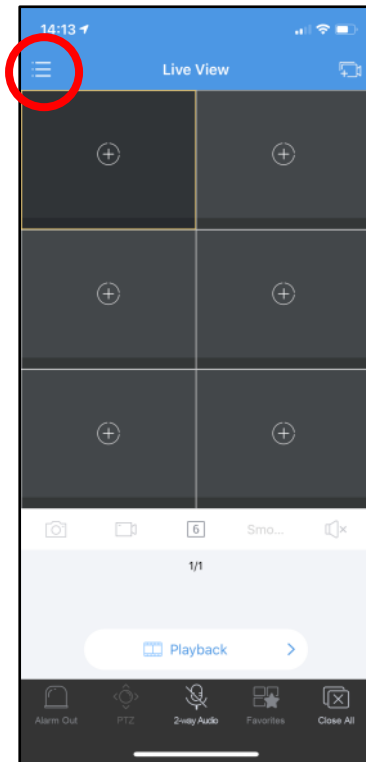

3. Click on **Devices**

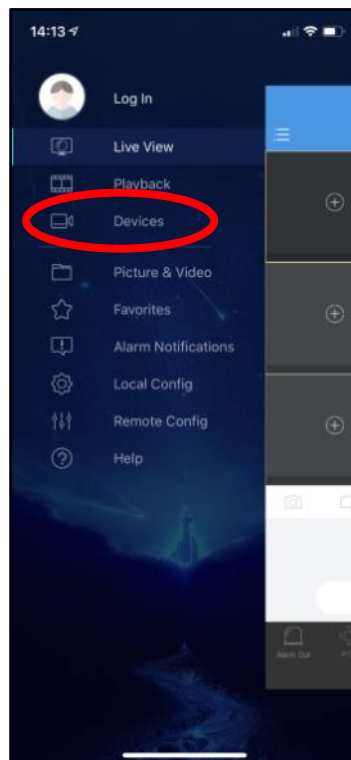

4. Click on **+ Add**

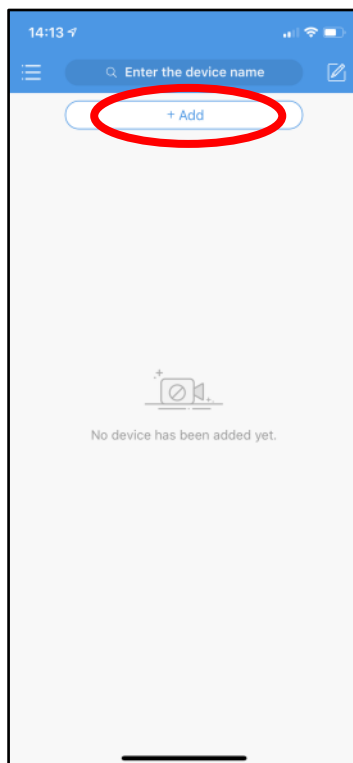

5. Click on **Manual Add**

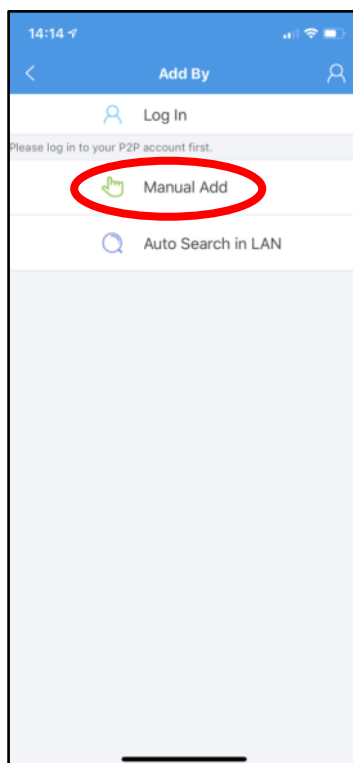

6. Enter a device name, and an address (this can be an IP address or a DDNS hostname). Then click on **Save** (top right corner)

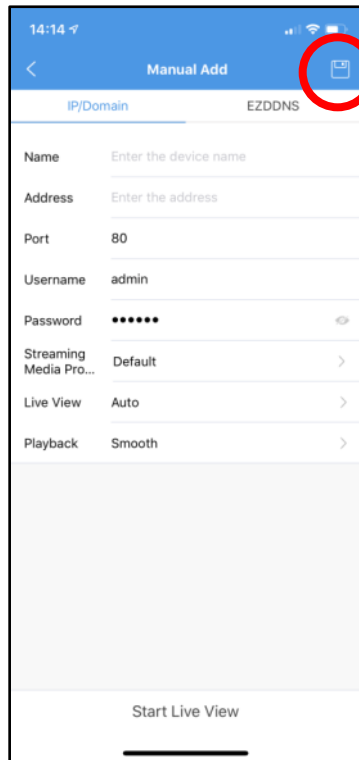

7. You should see your NVR in the device list; then click on the menu button.



8. Click on **Live View**

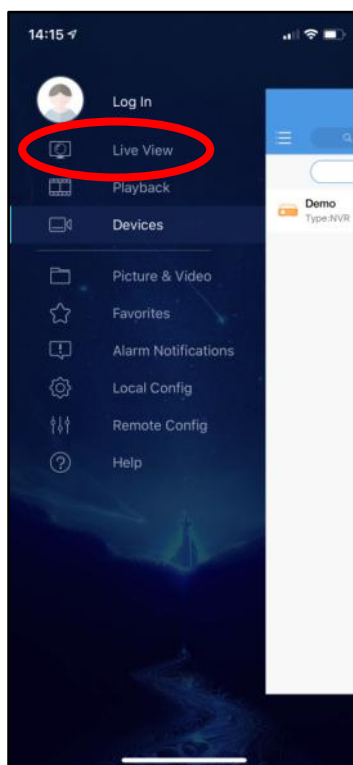

9. Click on the + on one of the squares

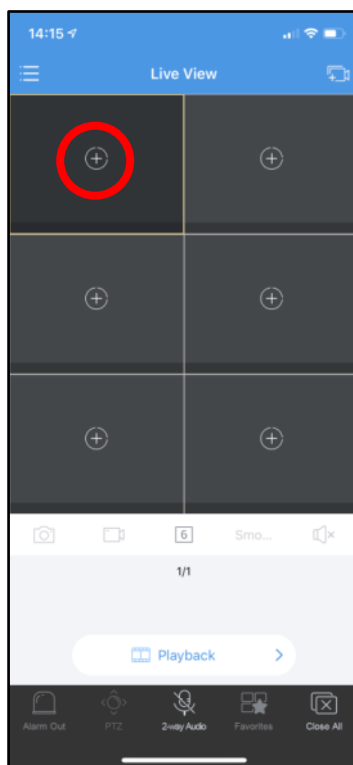

10. Click on the NVR you wish the live view, and then click on the camera/channel

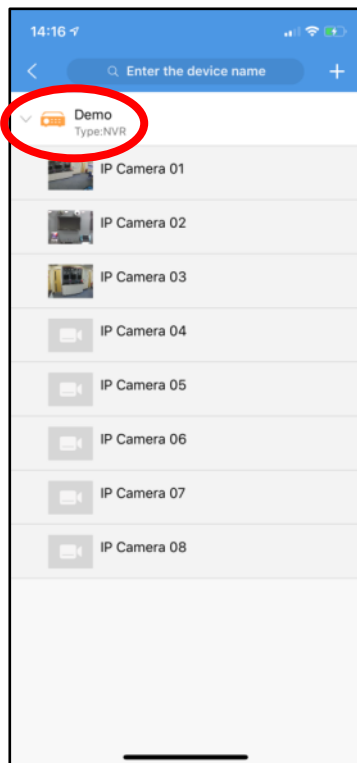

11. You should see the camera is streaming. Repeat steps 9 and 10 to view additional cameras simultaneously.

